



**RESORT  
LAS VEGAS**



# M RESORT SPA & CASINO

The breathtaking views, top-notch service and wide variety of menu choices at M Resort will make your meeting or convention nothing short of amazing. You'll find the perfect customizable event spaces for intimate gatherings to mid-size business events, as well as full audiovisual services, numerous catering options, and business services.



---

# TABLE OF CONTENTS

## 1 – THE HOTEL

Rooms & Suites

## 2 – MEETING SPACES

Conference Areas

## 3 – AMENITIES

The M Pool

Daydream Pool

Spa Mio

## 4 – DINING AT M RESORT

Anthony's

Marinellis

Raiders Tavern & Grill

Jayde at 16

The Vig Deli

Babycakes

Knight Time Hockey Bar

## 5 – UNIQUE SPACES

Lux Ballroom

Hostile Grape

AMP'D

M Pavilion





# 1 THE HOTEL



## WELCOME TO THE M RESORT

Enjoy panoramic views of the Las Vegas Strip and surrounding mountains through floor-to-ceiling windows that invite the outside in! Kick back by the pool with an ice-cold pineapple soft serve and soak in the sun. Dine on everything from stadium favorites to homemade pasta, burgers, prime steaks, and seafood! Make time for yourself with a workout or a spa day at our full-service salon and fitness center.

# THE M RESORT ROOM

SQ. FT: 550

Enter the M Resort hotel room and you're immediately greeted by rich woods, recessed lighting and clean lines. Stretch out on the inviting pillow-top mattress or relax in the deep soaking tub.

Floor-to-ceiling windows offer copious sunlight during the day and amazing views of the Las Vegas Strip or mountains in the evening. Enjoy tech features like high-speed internet, convenient USB outlets, and a 42-inch HD LED flat-screen TV.

## This room comes with:

- Your choice of a king or two queen beds with custom pillow-top mattresses
- Your choice of a Strip-view or mountain-view room\*
- Floor-to-ceiling windows offering outstanding views
- Armoire and closet with four-drawer storage
- Deep soaking bathtub and separate full shower
- Marble floors in bathroom
- Marble vanities with double sinks and vanity stool
- Inlaid mirror with built-in TV in bathroom
- Spacious built-in desk with executive chair
- Rollaway bed option available for rooms with king bed only

\*Nominal fee for Strip-view room.



KING



QUEEN



# CLASSIC SUITE

SQ. FT: 1,095

Add a little more luxury to your stay, along with some of the creature comforts of home. Your Classic Suite features a conversation bar, an elegant living room area and a separate powder room for your guests.

Enjoy an amazing view of the Strip through floor-to-ceiling windows. Relax on your king-size, custom pillow-top mattress. Take in a game on the 42-inch HD LED TV. Or enjoy some alone time lounging around in your complimentary bathrobes and slippers.

Accommodates 2 guests, up to 6 guests with connecting room.

## This room comes with:

- King-size bed with custom pillow-top mattress
- Floor-to-ceiling windows offering outstanding views of the Strip
- Conversation bar and living room area
- Separate powder room for guests
- Access to connecting rooms to create a two-bedroom suite
- Armoire and closet with four-drawer storage
- Deep soaking bathtub and separate full shower
- Marble floors in bathroom
- Marble vanities with double sinks and vanity stool
- Inlaid mirror with built-in TV in bathroom
- Spacious built-in desk with executive chair
- Rollaway bed option available for rooms with king bed only
- Complimentary bathrobes and slippers

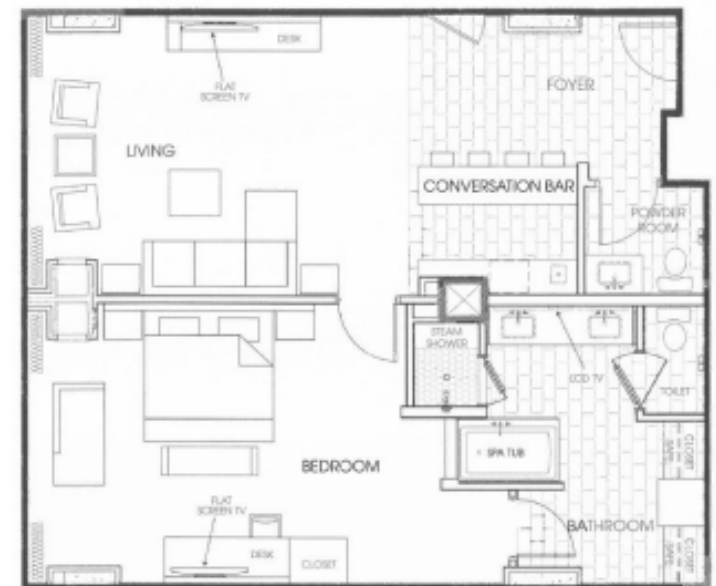



# FLAT SUITE

SQ. FT: 1,440

Looking for a room with a view? This is it. This corner suite gives you a 180-degree panoramic view of the Strip and the mountains. Details like etched glass sliding doors, mirrored closets and automated drapery add to this suite's style and sophistication. Entertain friends in the living room/conversation bar area. Take in the view from the corner daybed or while relaxing in the deep soaking bathtub. Cozy up in your king-size bed or catch a flick on the 42-inch HD LED TV.

*Accommodates 2 guests, up to 6 with suite option.*

## **This room comes with:**

- King-size bed with custom pillow-top mattress
- 180-degree panoramic view of the Strip and mountains through floor-to-ceiling windows
- Conversation bar and living room area
- Separate powder room for guests
- Access to connecting rooms to create a two-bedroom suite
- Armoire and closet with four-drawer storage
- Deep soaking bathtub with view of Strip or pool and separate full shower
- Marble floors in bathroom
- Marble vanities with double sinks and vanity stool
- Inlaid mirror with built-in TV in bathroom
- Spacious built-in desk with executive chair
- Rollaway bed option available
- Complimentary bathrobes and slippers
- Complimentary full-size bathroom toiletries

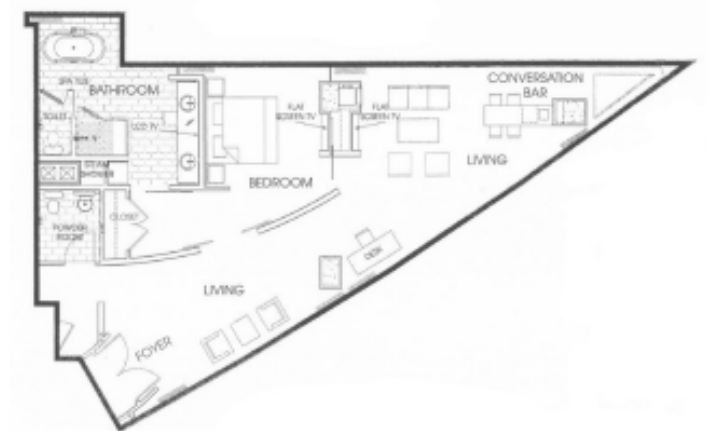



# LOFT SUITE

SQ. FT: 2,400

The ultimate in luxury awaits you in the Loft Suite. Enjoy a lavish two-story living space. Entertain friends downstairs in the spacious conversation bar/living room area. Get a great night's sleep upstairs in the elegant bedroom loft. Features include a shower that doubles as a steam room, an ornate stone and glass staircase, a 50-inch HD LED flat-screen TV that swivels to be viewed from anywhere in the first-floor living area, and 270-degree views of the Vegas skyline from both floors.

*Accommodates 2 guests, up to 10 with three-bedroom option.*

## **This room comes with:**

- Two-story design with private entry: living room area downstairs, bedroom loft upstairs
- King-size bed with custom pillow-top mattress
- 270-degree panoramic view of the Strip or mountains through floor-to-ceiling windows
- Conversation bar and living room area
- Separate powder room downstairs for visiting guests
- Walk-in shower that doubles as a steam room
- Access to connecting rooms to create a two- or three-bedroom suite
- Armoire and closet with four-drawer storage
- Deep soaking bathtub with view of Strip or pool
- Marble floors in bathroom
- Marble vanities with double sinks and vanity stool
- Inlaid mirror with built-in TV in bathroom
- Spacious built-in desk with executive chair
- Rollaway bed option available
- Complimentary bathrobes and slippers
- Complimentary full-size bathroom toiletries







# **2 MEETING SPACES**

# WHERE FORM MEETS FUNCTION

Impeccable service is combined with thoughtfully designed facilities that offer breathtaking views from the conference center. M Resort features more than 92,000 square feet of open and dynamic flexible spaces including the 25,000 square foot M Pavilion as well as multiple reception areas and a convenient business center. We've created our space for optimum customization, providing all the technology and connectivity features your meeting would ever require. Our turnkey approach makes planning your meeting a breeze. We're equipped to handle small to mid-size meetings and events and if your group is large enough, you could make the entire M Resort your personal playground. Rest assured, our staff will be there to cater to your every need.



# MILAN BALLROOM

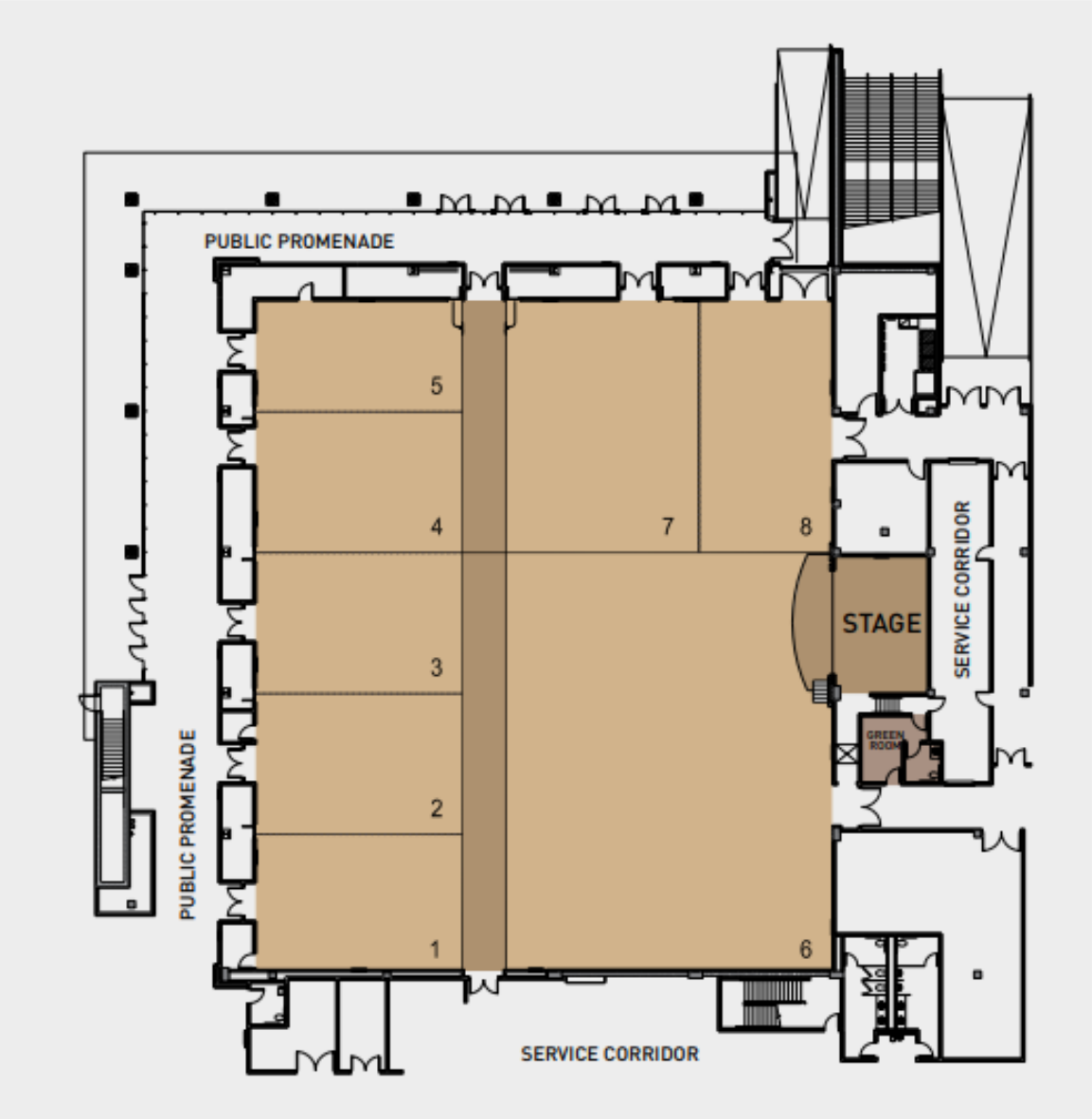

# MILAN

Dimensions

10x10

Room Name	Sq. Ft.	W	L	Ceiling	Theater	Classroom*	Banquet**	Reception	U-shape	H-square	Conference	Exhibits
<b>Main</b>	<b>17324</b>	<b>122</b>	<b>142</b>	<b>18</b>	<b>1905</b>	<b>1140</b>	<b>1236</b>	<b>1645</b>	<b>N/A</b>	<b>N/A</b>	<b>N/A</b>	<b>86</b>
Room 1	1320	30	44	18	145	86	108	125	32	36	28	7
Room 2	1320	30	44	18	145	86	108	125	32	36	28	7
Room 3	1320	30	44	18	145	86	108	125	32	36	28	7
Room 4	1320	30	44	18	145	86	108	125	32	36	28	7
Room 5	1056	24	44	18	85	65	72	100	26	30	28	5
Room 6	6230	70	89	18	685	375	420	600	N/A	N/A	N/A	32
Room 6***	7031	79	89	18	725	430	444	670	N/A	N/A	N/A	35
Room 7	1890	35	54	18	208	123	144	180	40	48	36	9
Room 7***	2376	44	54	18	262	155	168	230	48	58	42	12
Room 8	1890	35	54	18	208	123	144	180	40	48	36	9
Freight Door/Rm 8		10	14									
Stage	600	30	20									
Stage Plus Proscenium	900	30	30									



# MONTESE BALLROOM

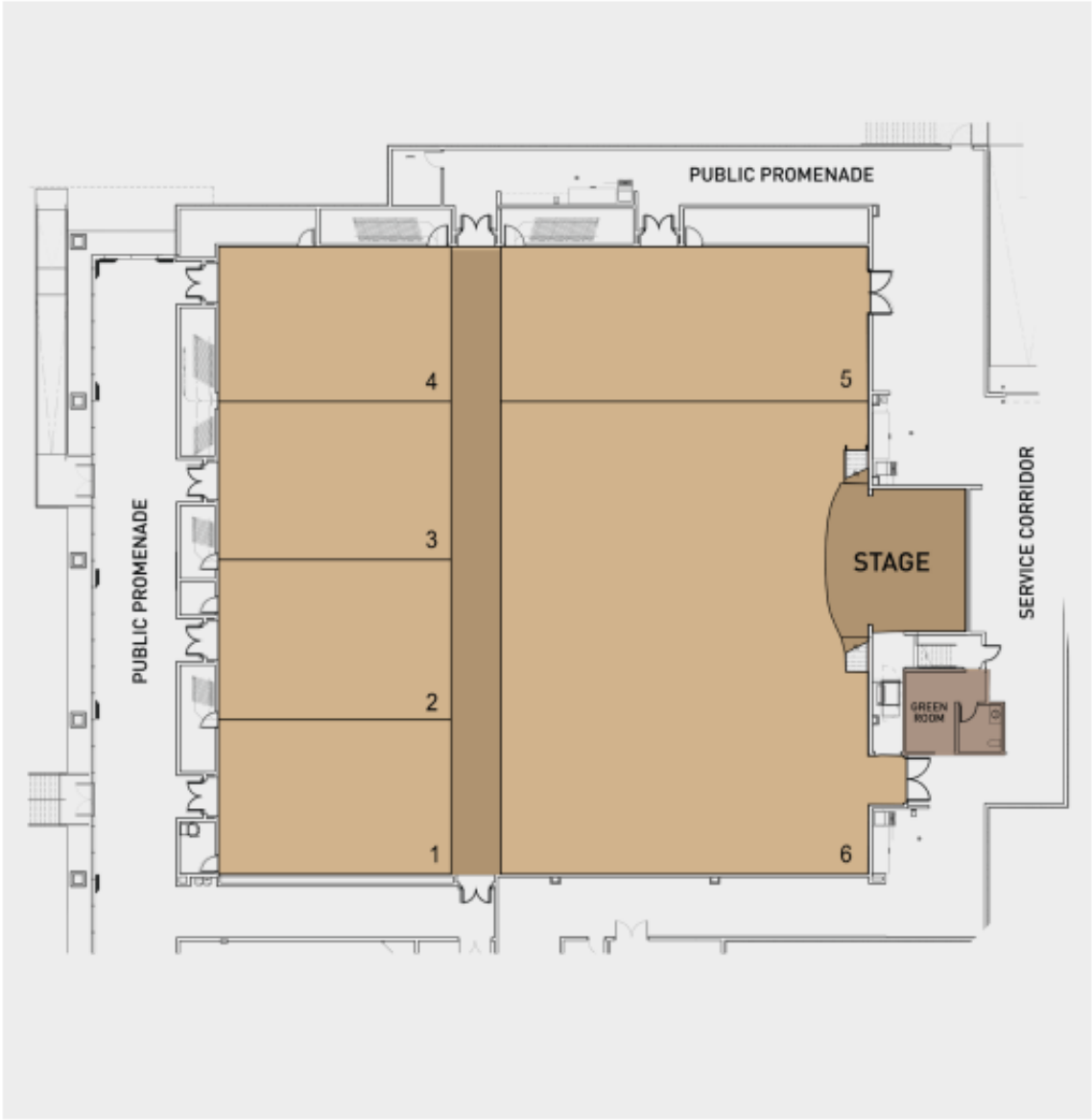

# MONTESE

Dimensions

10x10

Room Name	Sq. Ft.	W	L	Ceiling	Theater	Classroom	Banquet	Reception	Conference	Exhibits
<b>Main</b>	<b>14458</b>	<b>123</b>	<b>142</b>	<b>18</b>	<b>1611</b>	<b>828</b>	<b>1200</b>	<b>1526</b>	<b>N/A</b>	<b>72</b>
Room 1	1320	30	44	18	145	86	108	125	28	7
Room 2	1320	30	44	18	145	86	108	125	28	7
Room 3	1320	30	44	18	145	86	108	125	28	7
Room 4	1320	30	44	18	145	86	108	125	28	7
Room 5	2016	30	89	18	222	114	160	211	N/A	10
Room 5**	2277	30	98	18	255	129	190	242	N/A	11
Room 6	6186	90	89	18	677	348	500	642	N/A	30
Room 6**	6987	90	98	18	777	399	380	737	N/A	35
Stage	600	30	20							
Stage Plus Proscenium	900	30	30							



# CONFERENCE LEVEL MEETING AREAS

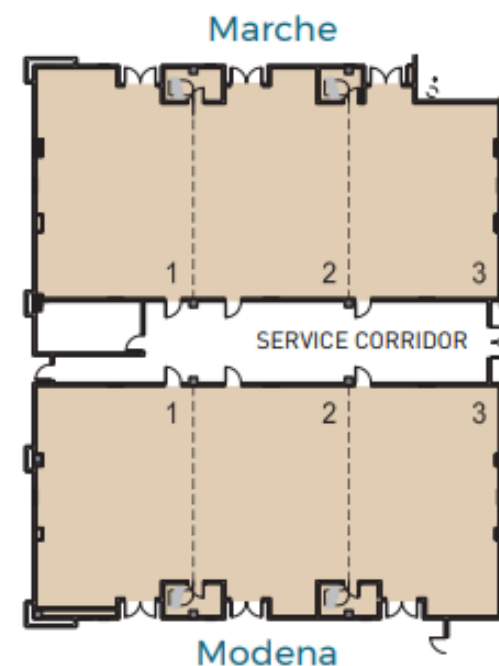
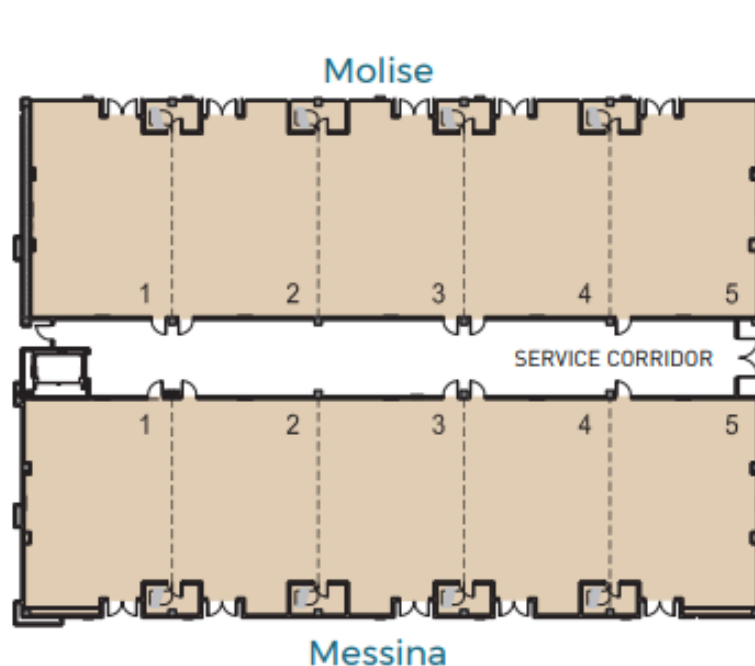

## MOLISE

Dimensions

10x10

Room Name	Sq. Ft.	W	L	Ceiling	Theater	Classroom*	Banquet**	Reception	U-shape	H-square	Conference	Exhibits
<b>Main</b>	<b>5662</b>	<b>149</b>	<b>38</b>	<b>12</b>	<b>595</b>	<b>350</b>	<b>385</b>	<b>520</b>	<b>85</b>	<b>110</b>	<b>70</b>	<b>30</b>
Room 1	1102	29	38	12	114	68	88	110	30	35	25	6
Room 2	1140	30	38	12	121	70	88	110	30	35	25	6
Room 3	1140	30	38	12	121	70	88	110	30	35	25	6
Room 4	1140	30	38	12	121	70	88	110	30	35	25	6
Room 5	1140	30	38	12	121	70	88	110	30	35	25	6

# MODENA

Dimensions

10x10

Room Name	Sq. Ft.	W	L	Ceiling	Theater	Classroom*	Banquet**	Reception	U-shape	H-square	Conference	Exhibits
<b>Main</b>	<b>3382</b>	<b>89</b>	<b>38</b>	<b>12</b>	<b>363</b>	<b>210</b>	<b>230</b>	<b>305</b>	<b>70</b>	<b>75</b>	<b>70</b>	<b>16</b>
Room 1	1140	30	38	12	121	70	88	110	30	35	25	6
Room 2	1140	30	38	12	121	70	88	110	30	35	25	6
Room 3	1102	29	38	12	114	68	88	110	30	35	25	6

# MARCHE

Dimensions

10x10

Room Name	Sq. Ft.	W	L	Ceiling	Theater	Classroom*	Banquet**	Reception	U-shape	H-square	Conference	Exhibits
<b>Main</b>	<b>3382</b>	<b>89</b>	<b>38</b>	<b>12</b>	<b>363</b>	<b>210</b>	<b>230</b>	<b>305</b>	<b>70</b>	<b>75</b>	<b>70</b>	<b>16</b>
Room 1	1140	30	38	12	121	70	88	110	30	35	25	6
Room 2	1140	30	38	12	121	70	88	110	30	35	25	6
Room 3	1102	29	38	12	114	68	88	110	30	35	25	6

# MESSINA

Dimensions

10x10

Room Name	Sq. Ft.	W	L	Ceiling	Theater	Classroom*	Banquet**	Reception	U-shape	H-square	Conference	Exhibits
<b>Main</b>	<b>5662</b>	<b>149</b>	<b>38</b>	<b>12</b>	<b>595</b>	<b>350</b>	<b>385</b>	<b>520</b>	<b>85</b>	<b>110</b>	<b>70</b>	<b>30</b>
Room 1	1102	29	38	12	114	68	88	110	30	35	25	6
Room 2	1140	30	38	12	121	70	88	110	30	35	25	6
Room 3	1140	30	38	12	121	70	88	110	30	35	25	6
Room 4	1140	30	38	12	121	70	88	110	30	35	25	6
Room 5	1140	30	38	12	121	70	88	110	30	35	25	6

# 3 AMENITIES





## M Pool

M Resort's all-ages Resort Pool, is a 100,000 square foot venue which features two 5,460-square-foot heated, infinity edge pools, boasts two large whirlpool hot tubs, and is surrounded by lush palm trees and tropical landscaping. With a depth of three and a half feet at its deepest, and a nine-inch wading pool on each end, M Pool is easily enjoyed by guests of all ages. M Pool is the ultimate getaway from the congested Las Vegas Strip and a premiere locals destination, featuring upgraded amenities including 17 deluxe day beds, 13 private VIP cabanas, courteous chair-side service, and a full food and beverage menu of freshly prepared items that cover all of your poolside cravings.



# spa mio

M Resort's signature full-service Spa, Salon and Fitness Center is all about you and providing for your every need. Relax and reset in one of Spa Mio's 16 treatment rooms, sauna, steam and hot tub wet areas or take time for self-care in the full-service salon and state-of-the-art fitness center.

Choose the treatment that's right for you from our extensive list of specialized spa services.



A teal background with a white curved line starting from the top center and curving down towards the bottom right corner.

# **4 DINING AT M RESORT**

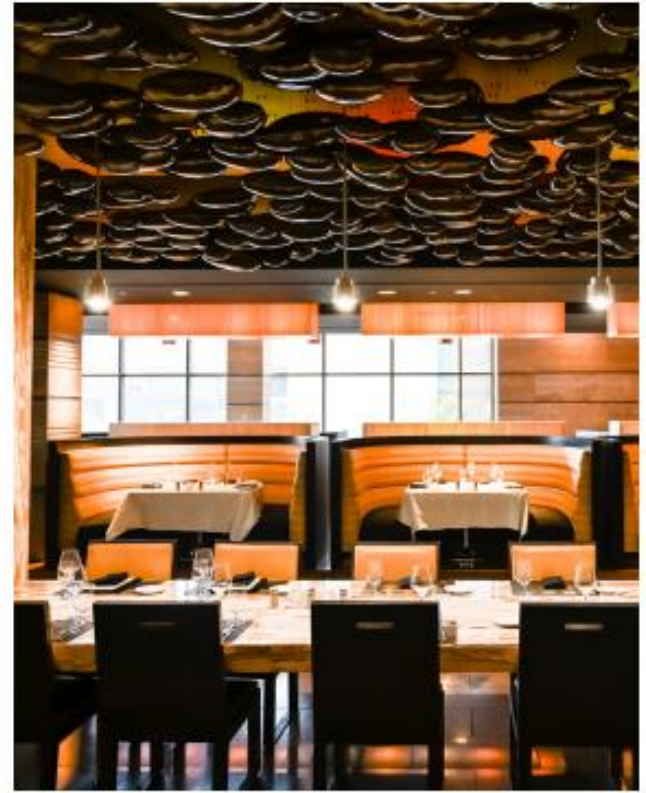

# Anthony's

PRIME STEAK & SEAFOOD

Enjoy prime steaks and fresh seafood, charcoal-grilled to perfection in an intimate dining space with spectacular customer service, or visit us for our Sunday Brunch Buffet featuring all you can eat lobster, prime rib, beef wellington, and more! Reservations are recommended.

Private Dining Room seats: **22**



  
*Marinelli's*  
AUTHENTIC ITALIAN DISHES

Enjoy authentic Italian dishes from Chicken Piccata and Veal Marsala to Risotto and Capellini Pomodoro with the sparkling lights of the Las Vegas Strip in the background.

# RAIDERS

## TAVERN & GRILL

### The World's First and Only Raiders-Themed Restaurant!

Featuring 3,400 square feet of dining space, two bars and 45 HDTVs, Raiders memorabilia and merchandise - Raiders Tavern & Grill celebrates the rich history of the Raiders along with great food and drinks and everything you need for gameday!

Private Dining Room seats: **24**





# Jayde @16

Experience the tastes of Asia from an intimate indoor dining space or rooftop patio high above the sparkling lights of the city.



Indulge in an excellent selection of coffees or order a specialty cake for any occasion. This one-of-a-kind bakery offers an impressive assortment of fresh-baked pastries, desserts, handmade gelatos and gourmet sandwiches. Try the signature cookies, red velvet cupcakes, coffee gelato, or eight-colored macarons. Complement your selection with a unique cappuccino or chai tea latte.



# **5** **UNIQUE SPACES**

# HOSTILE GRAPE

WINE CELLAR • BAR • TASTING ROOM

This stylish and intimate setting offers an exciting location for small receptions or pre- and post-meeting cocktails and appetizers. Live entertainment brings the experience to another level in this hip underground lounge.





# AMP'D

Form meets function in this multi-purpose entertainment venue. A built-in stage and dance floor along with an outdoor terrace that overlooks the Las Vegas Strip and convenient bar area create the perfect customizable destination for your next gathering of up to 400 guests.

---

# M PAVILION

When you want an out-of-the-ordinary meeting or event experience, look no further than the M Pavilion. The newest addition to M Resort's 92,000 square feet of dynamic meeting space is the ideal venue for expositions, catered events, high-energy concerts, boxing matches and other large-scale events. The 25,000 square foot M Pavilion offers open, expansive, pillar-less spaces for optimum configurations with a capacity of 2,300. Our premiere facility offers seamless ground level entry from the M Resort ballrooms to provide an exceptional guest experience. Add in the M Resort's signature four star service and you'll be ensured that your meeting and event needs are met at every level. The M Pavilion provides you with the flexibility to customize your special meeting, expo or other event all under one roof.

## **This space features:**

- Dimensions W x L: 120-by-210 feet
- Ceiling height: 43-foot peak of sloped ceiling
- Two loading doors: 12-by-12-foot
- Pick point: 2,000 lbs. maximum
- Floor load: 250 psf
- Electrical: Edison Plugs
- 60-foot covered concrete walkway open on the sides
- Reception event capacity: 1,800
- General session capacity: 1,300
- Theatre capacity: 2,300
- Banquet capacity- 130 tables at 10 seats: 1,300
- Exhibit Booths: 134 10-by-10-foot booths
- Stadium seating capacity: 2,288
- Fully carpeted
- 220 power in structure
- Electrical access every 30 feet for flexible vendor set up
- Internet: T1 lines
- HVAC equipped





For your next meeting or event, please contact:  
702-797-1930 or [mresortsales@pennentertainment.com](mailto:mresortsales@pennentertainment.com)

---

12300 Las Vegas Blvd South Henderson, NV 89044

702.797.1000 | [theMresort.com](http://theMresort.com) | [f](#) [x](#) [@](#)