



HUTTON  
HOTEL  
NASHVILLE

## MEETINGS & SPECIAL EVENTS



Vista Ballroom



Hillsboro Room



Analog Music Venue

A MEMBER OF



THE LEADING HOTELS  
OF THE WORLD®

1808 West End Avenue Nashville, Tennessee 37203  
reservations@huttonhotel.com // sales@huttonhotel.com  
main. 615.340.9333 sales. 615.712.2319  
[huttonhotel.com](http://huttonhotel.com) f t i /HuttonHotel



WRITERS STUDIOS  
AT HUTTON HOTEL







Midtown Room



West End Boardroom



Pre-Function Area

## MEETING SPACE FEATURES & AMENITIES

- Over 20,000 square feet of event space including nine flexible meeting rooms all located on one floor for easy access and a 5,000 square foot music venue for creative events
- Ballroom features 14-foot windows offering abundant natural light and 17-foot ceilings
- Multipurpose pre-function space
- Premium meeting furniture includes oversized rounds, plush chairs and a wide variety of linens at no additional fees
- A variety of inclusive menu packages or fully customizable menu packages
- Dedicated on-site Conference Service Manager to assist you during your meeting or event
- On-site AV representative
- Adjustable lighting throughout

## WEDDINGS

- Flexible spaces can shift from grand to intimate, ideal for wedding events ranging from rehearsal dinners, bridal brunches, receptions and more
- Experienced on-site Social Catering Manager to work with you every step of the way

## PARKING

Hutton Hotel offer 24-hour valet and self-parking in an on-site garage with 300 fully covered spaces for guests and event attendees.

## LOCATION

Hutton Hotel is located in the neighborhood of Midtown, just steps from Music Row and less than one mile from Downtown. Vanderbilt University is less than a half-mile down the road and Nashville International Airport (BNA) is a short eight-mile trip (approximately 20 minutes).

## OUR VENUES

	Dimensions	Sq Ft	M <sup>2</sup>	Ceiling
West End Boardroom	18' x 24'	486	45.15	11'
Midtown Room	27' x 23'	621	57.69	11'
Hillsboro Room	100' x 24'	2,400	222.97	13'
Hillsboro Rm 1 + Coat Rm	39' x 24'	936	86.96	13'
Hillsboro Room 2	29' x 24'	696	64.66	13'
Hillsboro Room 3	31' x 24'	744	69.12	13'
Vista Ballroom	83' x 83'	7,000	650.32	17'
Vista Ballroom A	41' x 30'	1,230	114.27	17'
Vista Ballroom B	41' x 30'	1,230	114.27	17'
Vista Ballroom A + Hall	41' x 41'	1,681	156.17	17'
Vista Ballroom B + Hall	41' x 41'	1,681	156.17	17'
Vista Ballroom C	41' x 41'	1,681	156.17	17'
Vista Ballroom D	41' x 41'	1,681	156.17	17'

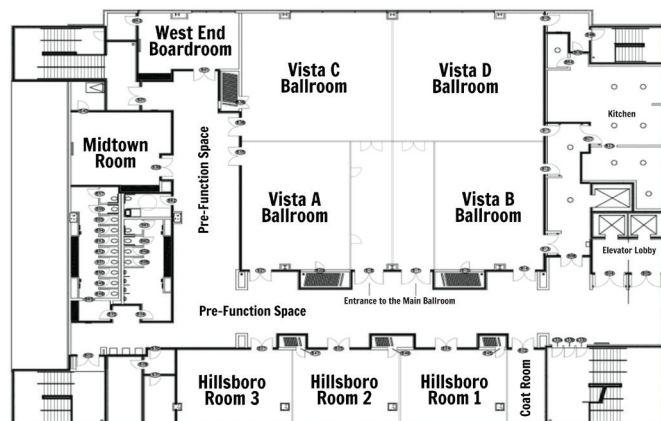

Smart Meetings  
2018 PLATINUM CHOICE  
AWARD WINNER



Sheena Wilkins Photography



Melanie Grady Photography



Shehew Photography