



**RESORT
LAS VEGAS**

WELCOME TO *M Resort*

THE OFFICIAL TEAM HEADQUARTERS HOTEL OF THE LAS VEGAS RAIDERS



Situated just south of the Las Vegas Strip, M Resort offers sweeping views of the valley and surrounding mountains through floor-to-ceiling windows that invite the outside in!



Hotel Lobby



M Resort Room





Classic Suite





Flat Suite





Loft Suite

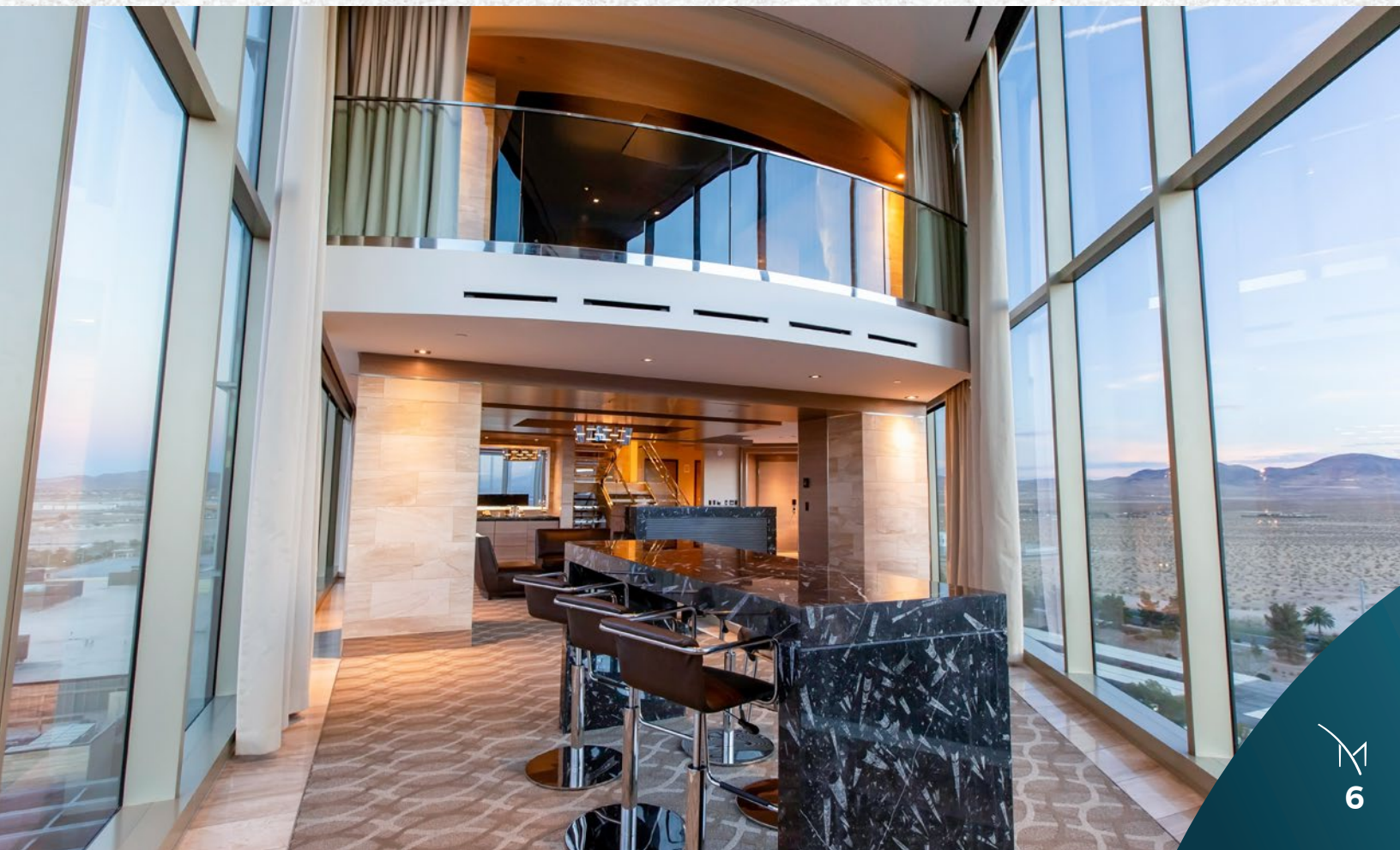



Anthony's

PRIME STEAK & SEAFOOD

Grilled to perfection

serving some of the best steaks and freshest seafood in the city.



Marinelli's

AUTHENTIC ITALIAN CUISINE

Pasta and italian fare made fresh.



Raiders Tavern & Grill

**THE WORLD'S FIRST AND ONLY
RAIDERS-THEMED RESTAURANT**

Great food and drinks, plus the silver & black experience.
Equipped with 2 full-service bars and a gift shop
featuring exclusive Raiders merchandise.



Jayde @16

ASIAN FUSION WITH A VIEW

Featuring a rooftop patio and an exclusive cocktail list!
Dine on favorites like sashimi, ramen, wagyu, and more.



The Vig Deli

An old school counter-style deli serving made-to-order sandwiches, wraps, salads and pizzas all day.



Baby Cakes

ARTISAN BAKERY

Satisfy your sweet tooth

Custom cakes, pastries, gelato and freshly brewed coffees all hours of the day.



Knight Time Hockey Bar

**CALLING ALL HOCKEY FANS -
THE PUCK DROPS HERE!**

Featuring Knights memorabilia, arcade games, private booths, tons of TVs, a full menu and the best local, Canadian, and classic brews all on tap.



M Bar

LIVE ENTERTAINMENT EVERY WEEK

Handcrafted cocktails by the glass or pitcher.

Video poker or slots right at the bar.

A stylish, relaxing lounge at the center of it all!



AMP'D

Designed around live entertainment, AMP'D boasts a high-energy cabaret environment, featuring great bands and DJs, bar-top gaming and specialty cocktails.



Casino Floor

Over 92,000 sq ft of gaming space featuring popular table games and the latest themed slots,
Plus an electronic table games stadium.



Spa Mio

FULL SERVICE SPA & SALON

16 Spa treatment rooms, separate men's and women's lounge areas that include a eucalyptus steam room, dry sauna and indoor hot tubs.



M Pool

Two 5500 sq. ft heated, infinity edge pools, featuring vip daybed and cabana seating in a family-friendly atmosphere.



Lux

SPECIAL EVENTS & WEDDING VENUE

Spectacular floor-to-ceiling views of the Las Vegas Strip
for your special event.



Convention and Meeting Space

92,000 sq ft of open and dynamic meeting and conference spaces providing optimum customization, technology and connectivity for turn-key events.

TOWER 1 CASINO LEVEL

BARS, LOUNGES & ENTERTAINMENT

- 1 KNIGHT TIME HOCKEY BAR
- 2 VUE BAR
- 3 M BAR
- 4 AMP'D

DINING

- 5 MARINELLI'S AUTHENTIC ITALIAN CUISINE
- 6 ANTHONY'S PRIME STEAK & SEAFOOD
- 7 BABY CAKES
- 8 RAIDERS TAVERN & GRILL
- 9 COORS LIGHT CHILL ZONE
- 10 VIG DELI
- 11 JAYDE@16

EVENTS

- 13 BOX OFFICE
- 14 M VUE

GAMING

- 15 BACCARAT & PAI GOW
- 16 PENN PLAY CENTER | CASHIER
- 17 RACE & SPORTS BOOK
- 18 GIFT CENTER
- 19 HIGH LIMIT SLOTS
- 20 OWNERS CLUB LOUNGE
- 21 ELECTRONIC TABLE GAMES STADIUM

HOTEL

- 22 GIFT SHOP
- 23 HOTEL LOBBY
- 24 VICE SHOP



TOWER 1 CONFERENCE LEVEL

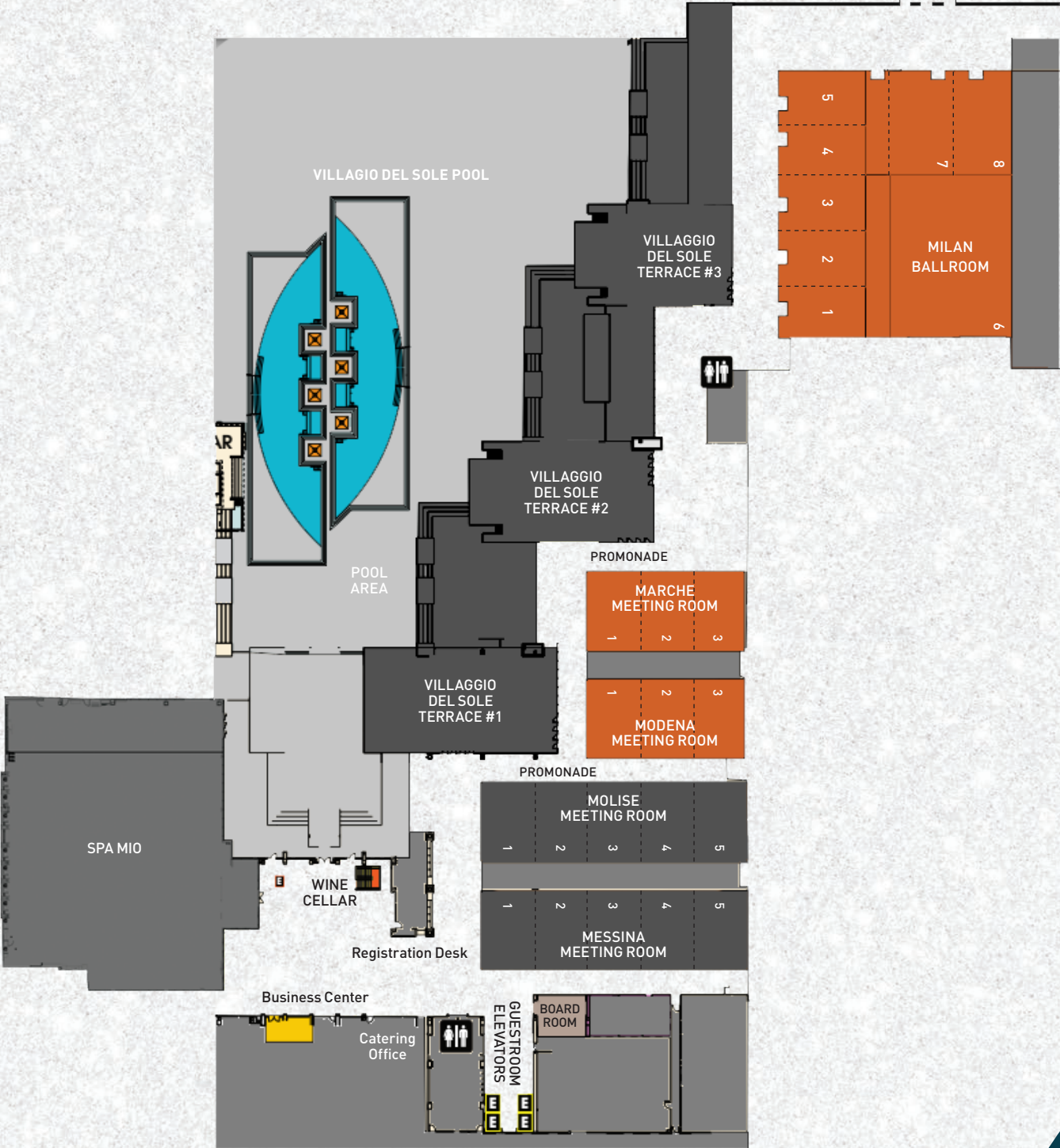

Tower 1 • Meeting Rooms

Meeting Room Capacities

Marche

Room Name	Sq. Ft.	Dimensions		Ceiling	Theater	Classroom*	Banquet**	Reception	U-shape	H-square	Conference	Exhibits
		W	L									
Main	3382	89	38	12	363	210	230	305	70	75	70	16
Room 1	1140	30	38	12	121	70	88	110	30	35	25	6
Room 2	1140	30	38	12	121	70	88	110	30	35	25	6
Room 3	1102	29	38	12	114	68	88	110	30	35	25	6

Modena

Room Name	Sq. Ft.	Dimensions		Ceiling	Theater	Classroom*	Banquet**	Reception	U-shape	H-square	Conference	Exhibits
		W	L									
Main	3382	89	38	12	363	210	230	305	70	75	70	16
Room 1	1140	30	38	12	121	70	88	110	30	35	25	6
Room 2	1140	30	38	12	121	70	88	110	30	35	25	6
Room 3	1102	29	38	12	114	68	88	110	30	35	25	6

Molise

Room Name	Sq. Ft.	Dimensions		Ceiling	Theater	Classroom*	Banquet**	Reception	U-shape	H-square	Conference	Exhibits
		W	L									
Main	5662	149	38	12	595	350	385	520	85	110	70	30
Room 1	1102	29	38	12	114	68	88	110	30	35	25	6
Room 2	1140	30	38	12	121	70	88	110	30	35	25	6
Room 3	1140	30	38	12	121	70	88	110	30	35	25	6
Room 4	1140	30	38	12	121	70	88	110	30	35	25	6
Room 5	1140	30	38	12	121	70	88	110	30	35	25	

Messina

Room Name	Sq. Ft.	Dimensions		Ceiling	Theater	Classroom*	Banquet**	Reception	U-shape	H-square	Conference	Exhibits
		W	L									
Main	5662	149	38	12	595	350	385	520	85	110	70	30
Room 1	1102	29	38	12	114	68	88	110	30	35	25	6
Room 2	1140	30	38	12	121	70	88	110	30	35	25	6
Room 3	1140	30	38	12	121	70	88	110	30	35	25	6
Room 4	1140	30	38	12	121	70	88	110	30	35	25	6
Room 5	1140	30	38	12	121	70	88	110	30	35	25	6

*Classroom seating based on 4 people per 8' table. **Banquet seating based on 12 people per 72" round table.
Capacities are subject to change based on allowances for head tables, staging, audio visual and catering requirements. ***Inclusive of Corridor Area.

Marche

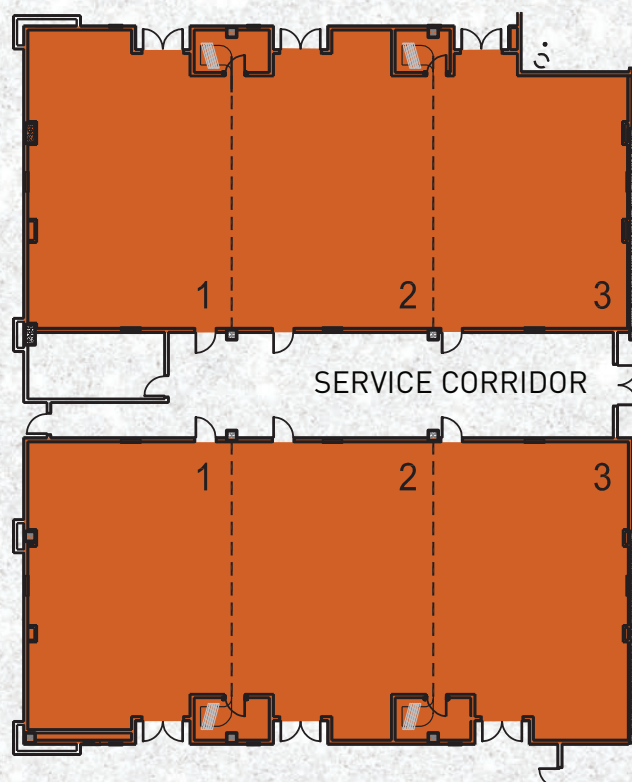

Modena

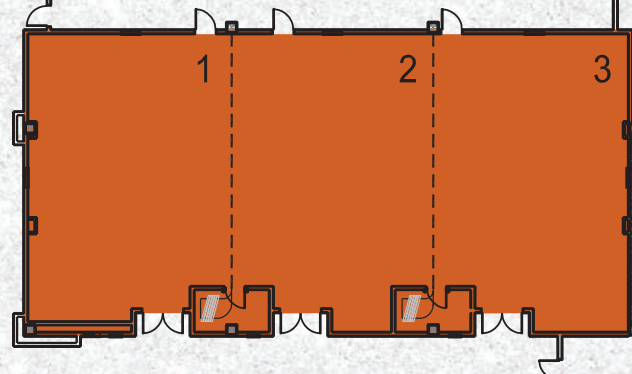

Molise

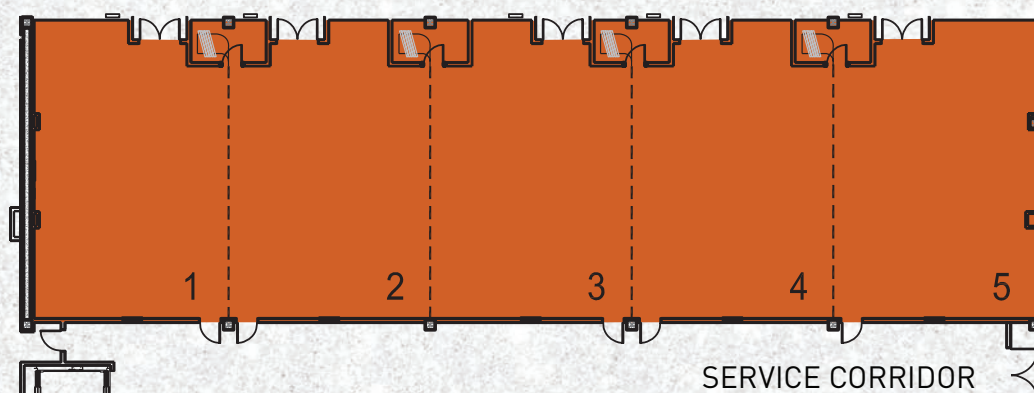

Messina

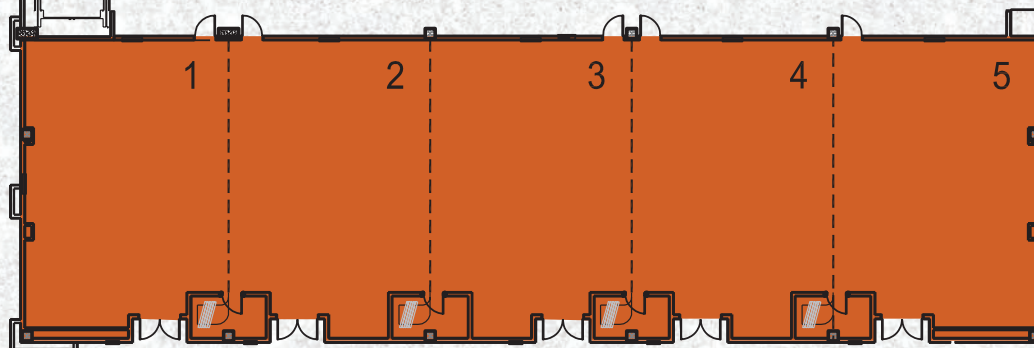

Tower 1 • Ballroom

Ballroom Capacities

Milian

Room Name	Sq. Ft.	Dimensions		Ceiling	Theater	Classroom*	Banquet**	Reception	U-shape	H-square	Conference	Exhibits
		W	L									
Main	17324	122	142	18	1905	1140	1236	1645	N/A	N/A	N/A	86
Room 1	1320	30	44	18	145	86	108	125	32	36	28	7
Room 2	1320	30	44	18	145	86	108	125	32	36	28	7
Room 3	1320	30	44	18	145	86	108	125	32	36	28	7
Room 4	1320	30	44	18	145	86	108	125	32	36	28	7
Room 5	1056	24	44	18	85	65	72	100	26	30	28	5
Room 6	6230	70	89	18	685	375	420	600	N/A	N/A	N/A	32
Room 6***	7031	79	89	18	725	430	444	670	N/A	N/A	N/A	35
Room 7	1890	35	54	18	208	123	144	180	40	48	36	9
Room 7***	2376	44	54	18	262	155	168	230	48	58	42	12
Room 8	1890	35	54	18	208	123	144	180	40	48	36	9
Freight Door/Rm 8		10	14									
Stage	600	30	20									
Stage Plus Proscenium	900	30	30									

M Boardroom

Room Name	Sq. Ft.	Dimensions		Ceiling	Theater	Classroom*	Banquet**	Reception	U-shape	H-square	Conference	Exhibits
		W	L									
Boardroom	405	27	15	10	N/A	N/A	N/A	N/A	N/A	N/A	10	N/A

Wine Cellar

Room Name	Sq. Ft.	Dimensions		Ceiling	Theater	Classroom*	Banquet**	Reception	U-shape	H-square	Conference	Exhibits
		W	L									
Wine Cellar	5,000				N/A	N/A	100	165	N/A	N/A	N/A	N/A

Group Desk / Villaggio Del Sole (outdoor)

Room Name	Sq. Ft.	Dimensions		Ceiling	Theater	Classroom*	Banquet**	Reception	U-shape	H-square	Conference	Exhibits
		W	L									
Registration Desk			50	11								
Office A	100	10	10	8								
Office B	132	11	12	8								
Villaggio Del Sole Terrace #1	6550	108	75	74			370	500				
Villaggio Del Sole Terrace #2	5460	92	63	14			320	450				
Villaggio Del Sole Terrace #3	4975	86	63	OPEN			270	400				
Wine Cellar	5000											

*Classroom seating based on 4 people per 8' table. **Banquet seating based on 12 people per 72" round table. Capacities are subject to change based on allowances for head tables, staging, audio visual and catering requirements. ***Inclusive of Corridor Area.

Milian

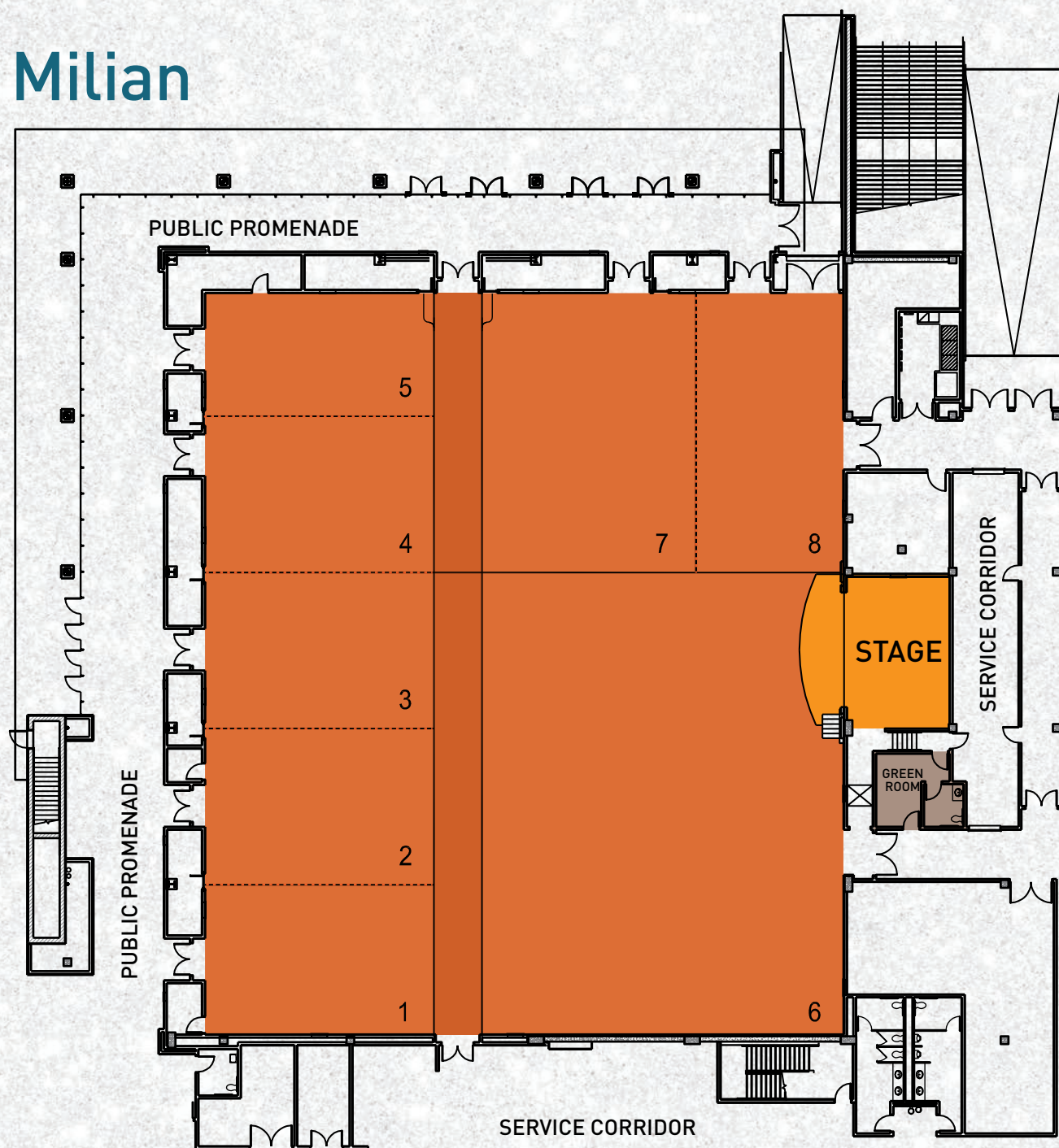

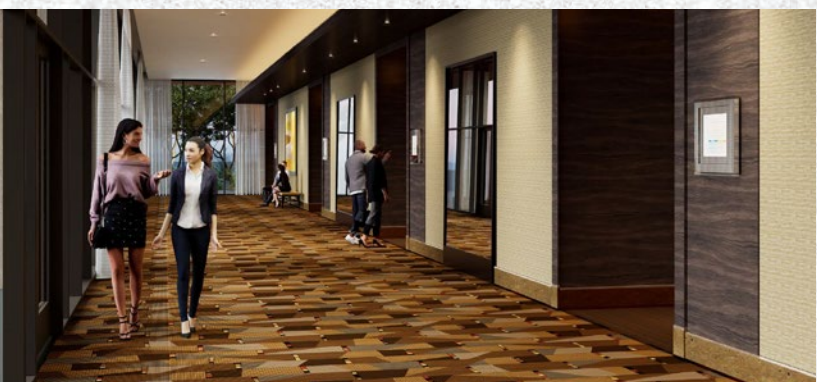

ADDITIONAL

Conference Space

2025

Tower 2 • Ballroom

Ballroom Capacities

Murano

Dimensions

Room Name	Sq. Ft.	W	L	Ceiling
Main	14,458	123'	118'	18'
Room 1	1,276	29'	44'	18'
Room 2	1,320	30'	44'	18'
Room 3	1,322	30'	44'	18'
Room 4	1,276	29'	44'	18'
Room 5**	2,277	29'	44'	18'
Room 6**	6,987	89'	79'	18'
Performance Platform	703	26'	27'	

** Room #5 Room #6 inclusive of corridor area.

Murano



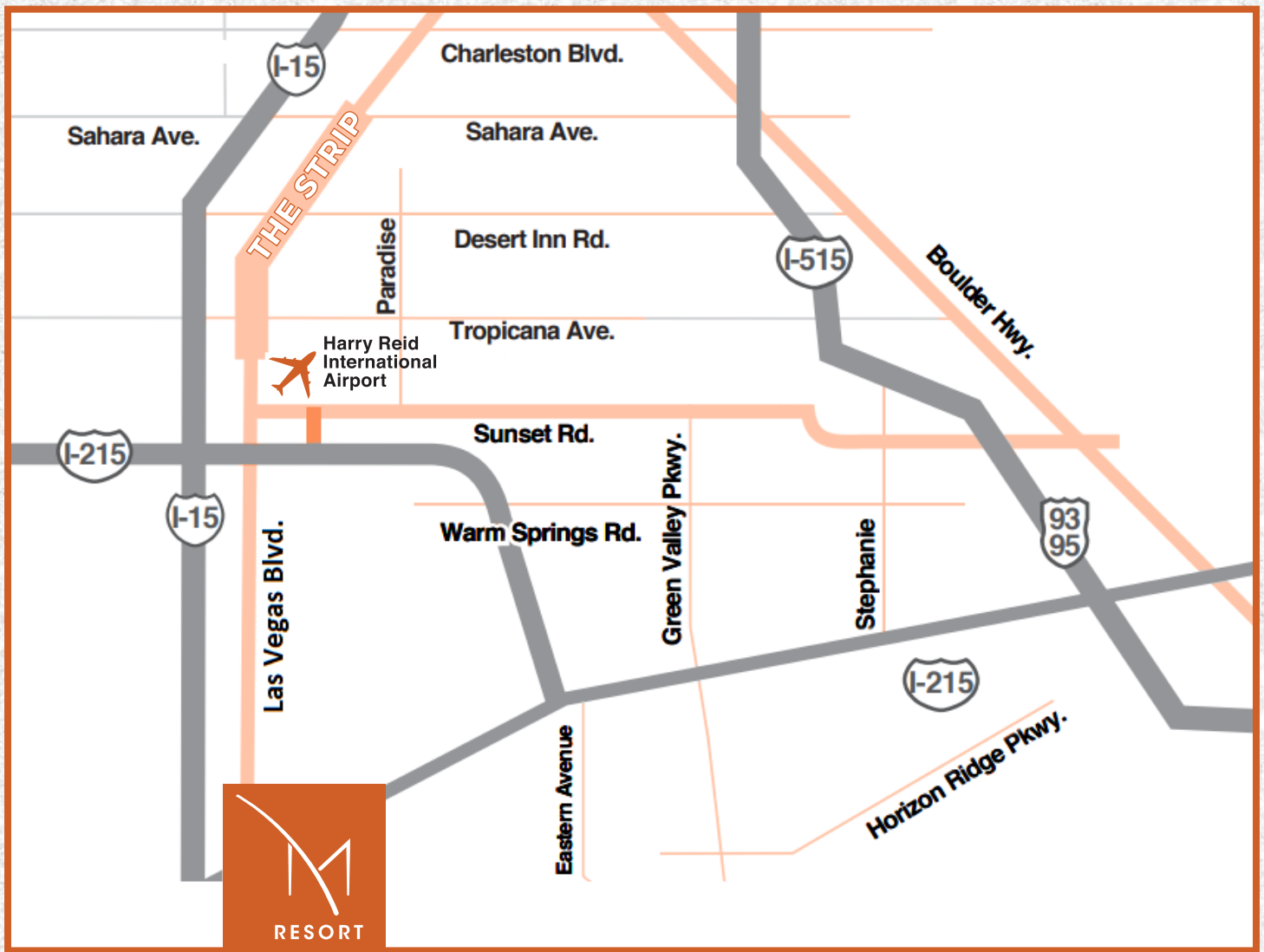



**RESORT
LAS VEGAS**

12300 Las Vegas Blvd South Henderson, NV 89044

P: 702.797.1000 • www.theMresort.com